

## FormTrap Repaginator

- ▶ Overview
- ▶ Loading a Sample Data
- ▣ Entry
  - ▶ New Entry - Header Area
  - ▶ Footer Area
  - ▶ Data Area
  - ▶ Rules
  - ▶ Properties
  - ▶ Evaluation Order of Entries
  - ▶ Evaluation Order of Areas
  - ▶ Delete an Entry, Area or Rule
- ▣ Tools

### Properties

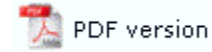

Once you have finished creating the areas in the entry, you can modify the entry and area properties.

#### Entry Properties

To modify the properties of the selected entry:

- Choose Entry from the Edit menu or select the entry in the Areas window and click the Properties tool  button on the toolbar.
- The Entry dialog box opens.
- To change the name of your entry, enter the name in the Name text box. You should give your entry a meaningful name that represents the type of data the entry has been created for.
- To insert text at the beginning of each page, enter the string in the Prepend with text box.
- To insert text at the end of each page, enter the string in the Append with text box. This feature is used to insert `##NEWDOC#` which allows processing of multiple similar documents from one file. The next (Form Feed) option is not required when the `##NEWDOC#` command is inserted. You can insert another document behind this one via these commands (typically used to insert a one-page terms and conditions document behind an invoice or PO):
  - `##F#<form-name>#` where form-name is the name of the required form
  - 0 (record mode) or just some data such as "base page" (print line mode)
  - `##NEWDOC#`
- To insert a form feed at the end of each document, tick the Form feed at the end checkbox.
- Click OK to save the changes.

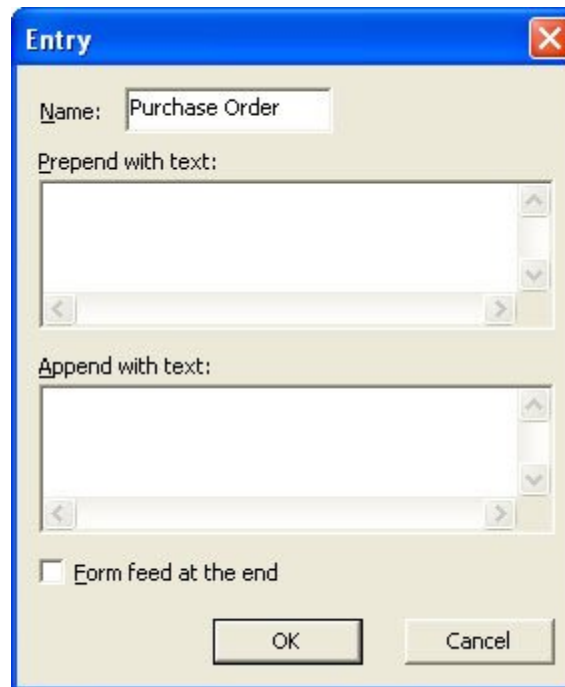

[Top](#)

## Area Properties

Once the areas have been defined, you can modify the properties of the areas, including the height of the selected area and the properties of the rules on the selected area.

In the data area(s), you also have the option to suppress the output. This is the normal approach to repagination, suppress all that you do NOT want, leaving all of the remaining non-blank lines as the "keepers".

To modify the properties of the selected area:

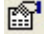
- Select the area to be modified in the Areas window and choose Properties from the Edit menu or click the Properties tool  button on the toolbar.
- In the Area dialog opens,
- Change the height of the selected area, enter the new height (i.e. the number of lines) in the Height text box.
- Select the properties of the rules defined on the selected area:
  - All must succeed - All of the rules defined on the selected area must succeed to identify this area.
  - Any can succeed - At least one of the rules defined on the selected must succeed to identify this area.
- Suppress output option is only applicable to data areas. To suppress the output from the selected data area (i.e. to not have it printed in the output from the

repagination process), tick the Suppress output checkbox. The data area icon in the Areas window changes to show it will be suppressed in the output.

- Click OK to save the changes.

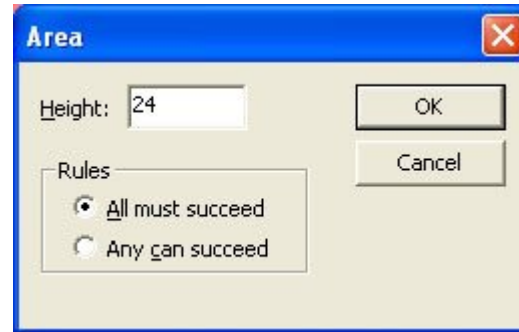

[Top](#)